



Aston Cantlow Road , Wilmcote
Stratford upon Avon, CV37 9XN

Guide Price £315,000



A chance to acquire a charming characterful cottage, nestled in the heart of the picturesque and historic village of Wilmcote. Positioned to the north side of Stratford upon Avon, Wilmcote is a fantastic village with a thriving community, easy access to main road links and a wealth of amenities including a local shop, public house, primary school, church and train station.

The cottage, believed to date back to the 1800's, is part of a row of historic miners cottages and is full of beautiful period features, whilst offering all the comforts of modern day living. Internally, the property is entered via a porch into a Dining Kitchen, with the fitted kitchen benefitting from a range of wall and base units and integrated appliances and plenty of space for a dining table. An archway opens up into the Living Room; a lovely bright room with a central log burner and under stairs storage.

To the first floor, the Principle Bedroom has a semi-vaulted ceiling, adding to the feeling of space, and built-in wardrobes. The second bedroom; a generous single, could also be utilised as a home office. The properties bathroom offers a four-piece suite with freestanding bath, shower enclosure, WC and sink unit.

One of the standout features of this home is the generous, south-facing garden, offering a wonderful opportunity for gardening enthusiasts or those who simply wish to enjoy the tranquillity of their surroundings. The garden is currently mainly laid to lawn, with some planting and a patio area. A gate at the end of the garden leads out to the parking area, where the property benefits from a single garage and two parking spaces.

To the front of the property, a brick-built outhouse provides utility space with plumbing for white goods and additional storage.





Tax Band:

Council: Stratford District Council

Tenure: Freehold

Floor Plan

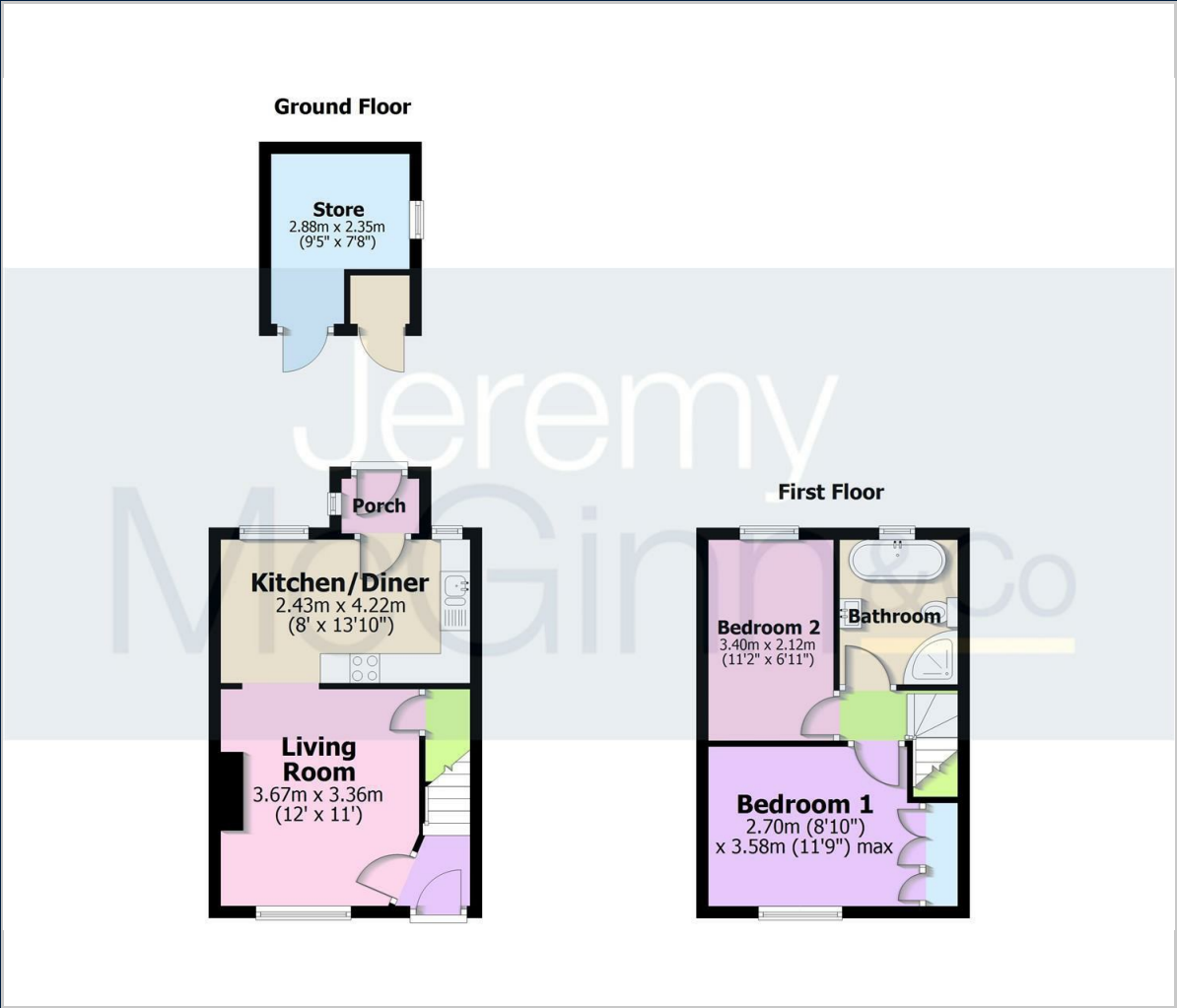

Map



Energy Performance

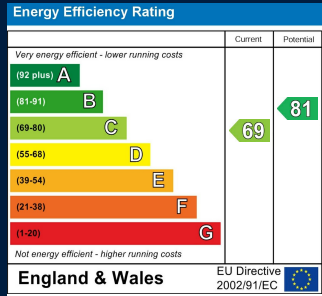

These particulars, whilst believed to be accurate are set out as a general outline only for guidance and do not constitute any part of an offer or contract. Intending purchasers should not rely on them as statements of representation of fact, but must satisfy themselves by inspection or otherwise as to their accuracy. No person in this firms employment has the authority to make or give any representation or warranty in respect of the property.